

BT CABLE, BERRY HEAD, TORBAY

(NGR SX 94298 56525)

Results of an archaeological watching brief

Prepared by:
Andrew Passmore BSc MIfA

On behalf of:
BT Openreach

Document No: ACD734/1/0

Date: August 2013

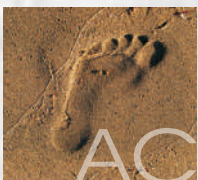

AC archaeology

Torbay Council Historic Environment Record

Civil Parish & District: Brixham, Torbay	National Grid Reference Centred on SX 94298 56525	Number: (Leave blank for HES to fill in)
Subject: BT Cable, Berry Head: Results of an archaeological watching brief		Photo attached? N
Planning Application no: N/A	Recipient museum: Brixham Museum	
OASIS ID: 156418	Museum Accession no: N/A	
Contractor's reference number/code: ACD734	Dates fieldwork undertaken: 24 July 2013	
<p>Introduction</p> <p>A watching brief was carried out by AC archaeology during emergency repairs to the BT cable supplying buildings within Fort 3 at Berry Head, Brixham (Fig. 1). The repairs were required following a lightning strike that had affected both telephone and electricity supplies to the lighthouse, coastguard station and café. Fort 3 is one of two Napoleonic-era fortifications constructed at Berry Head to strengthen the defences of the south coast in anticipation of a French attack. It is a Scheduled Monument (National Heritage List no. 1017322).</p> <p>Results (Figs 2-3)</p> <p>A 43m length of cable was replaced between the existing manhole inside the entrance (SX 94298 56512) and a point (at 94318 56530) adjacent to the corner of the boundary wall with the quarry to the northeast. The new service was laid adjacent to the existing cable, which was located 0.20m below the surface. The trench measured 0.30m wide by 0.25m deep, with its east end enlarged to 0.40m wide by 0.50m deep to accommodate a junction box. A short spur was also excavated from the box to the boundary wall. Here, to the north of the electricity cable, a water pipe was found 0.20m below the surface. The following deposit sequence was exposed:</p> <p>100 – 0.20-0.25m turf and topsoil. Light brown generally stone free compact (when baked dry) clayey silt with very rare slate, brick and clinker inclusions, the latter only present in the western 2m of the trench.</p> <p>101 – 0.05m + late 19th-century levelling deposit. Limestone fragments with some dark red and brown loose clayey silt.</p> <p>102 – tarmac path. At a distance of 8m from the west end of the trench a 1.30m wide tarmac path, aligned north-northwest-south-southeast was exposed below 100. Its depth was not fully revealed.</p> <p>A pit for a second junction box and an associated service trench was excavated adjacent to the east end of the boundary wall with the quarry. The pit for the box measured 1m long by 0.50m wide by 0.50m deep with the adjacent trench measuring 0.80m long by 0.30m wide. The following deposit sequence was exposed:</p> <p>103 – 0.25m turf and topsoil. Mid brown loose clayey silt with rare small limestone inclusions.</p> <p>104 – 0.25m + natural subsoil. Red brown clayey silt with more frequent limestone inclusions at depth.</p> <p>Comments</p> <p>No finds or features were exposed. Layer 101 represents a Napoleonic-era infilling and levelling of a natural hollow situated to the west of the landward ramparts. The same material was observed in 2009 during excavation in advance of the construction of the café extension to the guardhouse (Farnell 2009). The date of path 102 is unknown. It can be seen as a cropmark on modern aerial photographs and appears to lead towards a scrubby area (?hollow) east of the ramparts. It could be associated with the use of the fort during the Second World War, perhaps in relation to the original ROC post that was situated in this area.</p> <p>Reference</p> <p>Farnell, A., 2009, <i>Archaeological Excavation at the Guardhouse, Fort no. 3, Berry Head, Brixham, Devon</i>, Exeter Archaeology Report no. 09.88.</p>		
<p>A plan as well as any other relevant drawings must be attached showing the location and extent of site, areas investigated and features exposed.</p>		
Recorder: Andrew Passmore, AC archaeology	Date sent to HER: 21 August 2013	

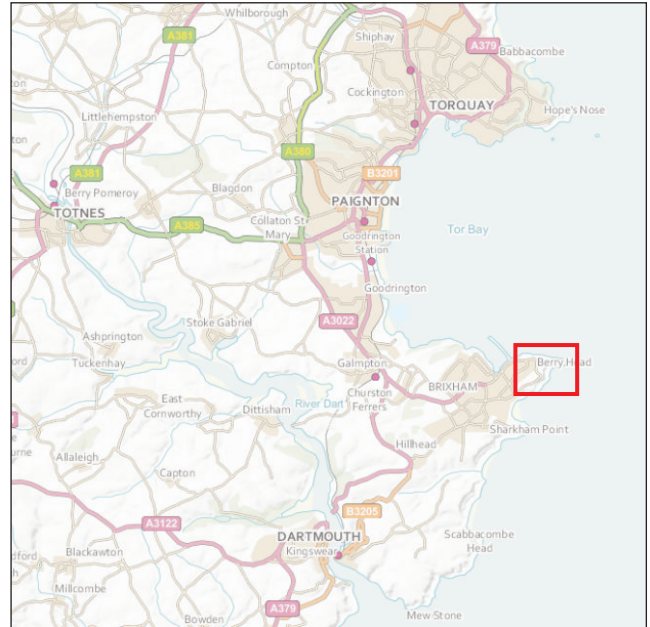
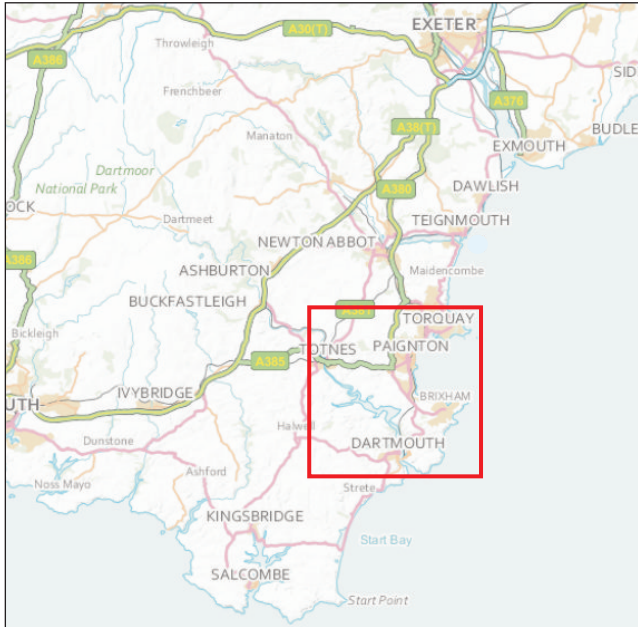

0 250m
 Scale 1:7500@A4

 Site location

PROJECT

Berry Head BT Cable, Torbay

TITLE

Fig. 1: Location of site

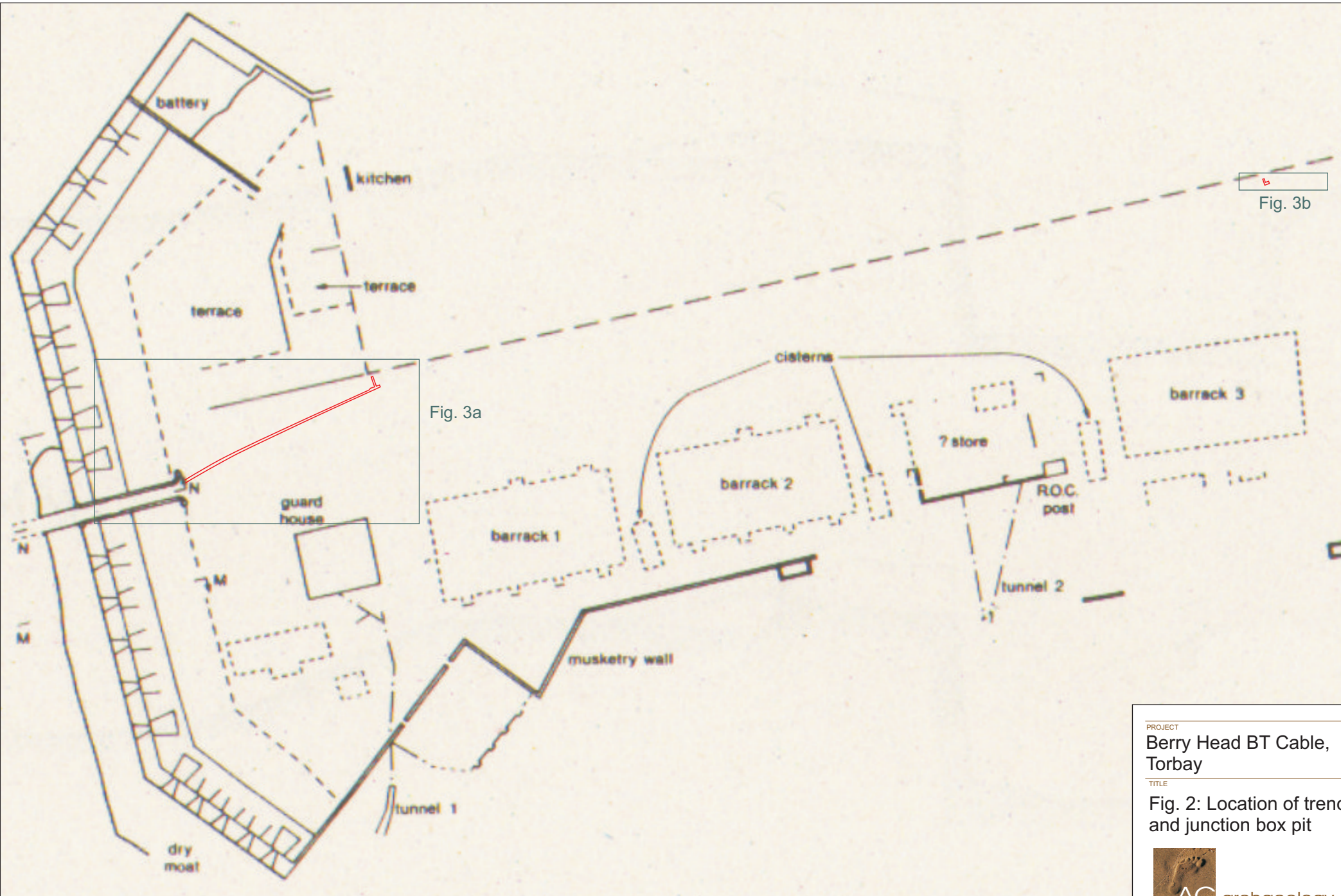
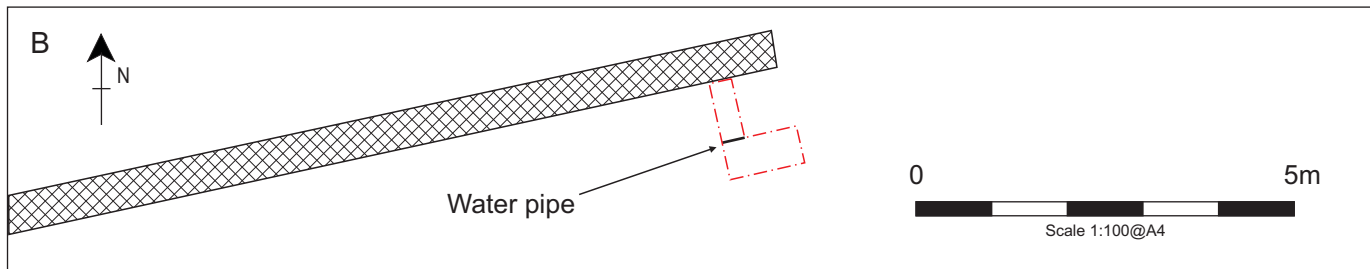
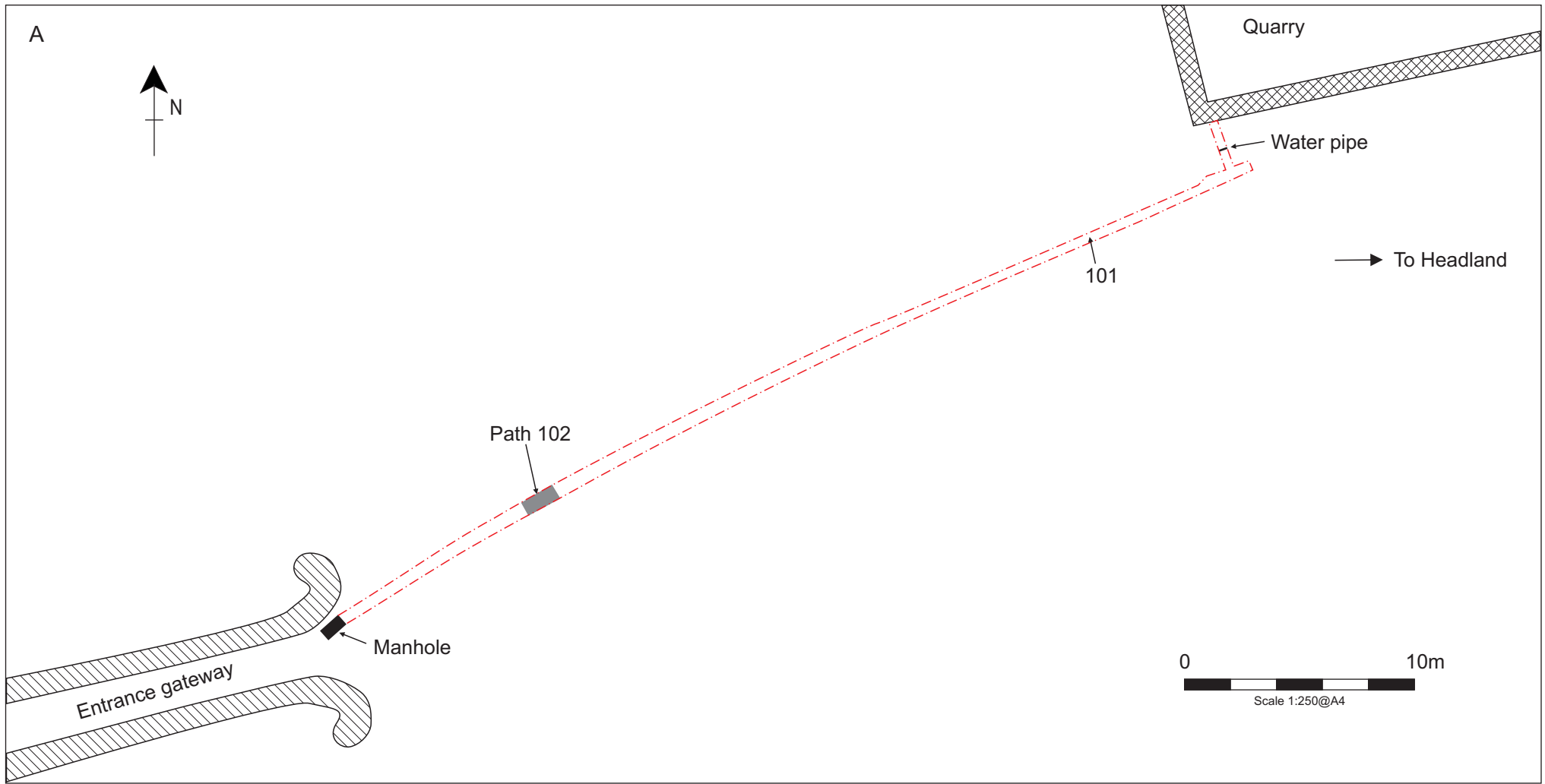

Fig. 3b

PROJECT
**Berry Head BT Cable,
 Torbay**

TITLE
**Fig. 2: Location of trench
 and junction box pit**

AC archaeology



PROJECT
 Berry Head BT Cable,
 Torbay

TITLE
 Fig. 3: Plans of trench
 and junction box pit



Devon Office

AC archaeology Ltd
Unit 4, Halthaies Workshops
Bradninch
Nr Exeter
Devon
EX5 4LQ

Telephone/Fax: 01392 882410

Wiltshire Office

AC archaeology Ltd
Manor Farm Stables
Chicklade
Hindon
Nr Salisbury
Wiltshire
SP3 5SU

Telephone: 01747 820581
Fax: 01747 820440

www.acarchaeology.co.uk